

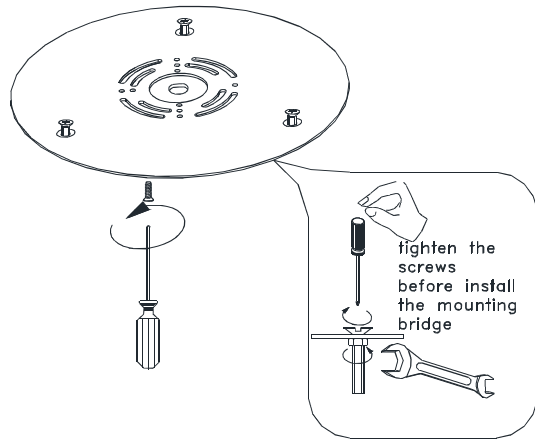

Contemporary
Lighting™

Installation Instructions

Model E22749-91PC



①

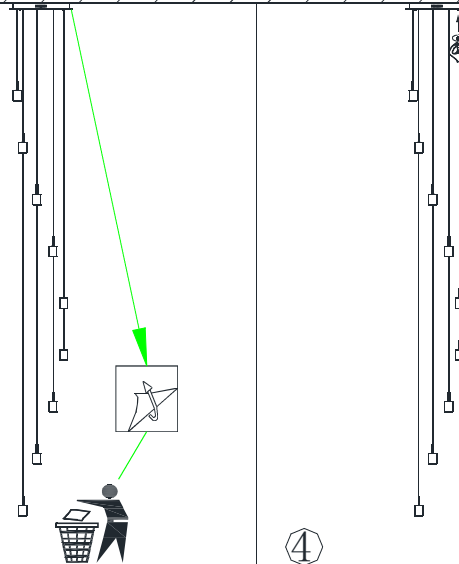

③

④

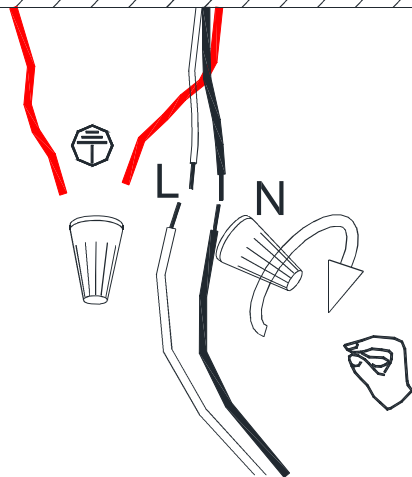

②

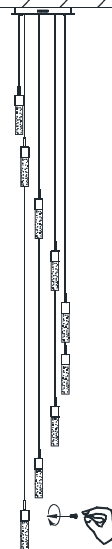

⑤

1. Turn breaker off for circuit on outlet where fixture is to be installed.
2. Remove mounting bracket from fixture and install to electrical box. (Figure 1)
3. Position back-plate onto mounting bracket and mark 3 holes onto ceiling for hollow wall anchors.
4. Remove back-plate from mounting bracket.
5. Drill 3 x 1/8" holes and insert hollow wall anchors.
6. Reinstall back-plate and secure to ceiling using 3 screws included into hollow wall anchors.
7. Wire fixture to wires in outlet box. Green wire is for Ground.
8. Install fixture to back-plate and tighten 4 nuts so that fixture meets the ceiling. (Figure 4)
9. Remove protective paper from fixture. (Figure 3)
10. Install glass into holders using 2 screws supplied (Figure 5)

WARNING!
THIS FIXTURE IS NOT DIMMABLE.
DO NOT USE WITH DIMMER OR DRIVER WILL BE DAMAGED!