

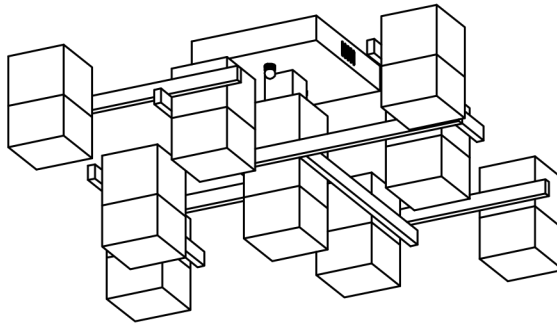

# Contemporary Lighting

PRODUCT NAME: NOVA  
ITEM NUMBER: E31200-75PC

Please consult your electrician for hanging fixture and wiring.



The fixture is designed to dim with a standard Triac forward phase dimmer. Dimming levels will vary by dimmer.

Below is a list of recommended dimmers:

Lutron MACL-153M

Lutron DVL-153P

Lutron SCL-153P

Leviton IPL06-10Z

Leviton 6674-POW

Due to the inrush current wattage should not exceed 150 watts of product for a 600 watt dimmer.

**WARNING:** Wires need to be connected to driver found in canopy and should not be connected directly to power source or a short may occur

**IMPORTANT: Turn OFF the power at the main fuse or circuit breaker box before starting installation**

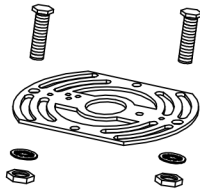

(A)  
Mounting bar

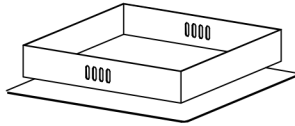

(B)  
Canopy



(C)  
Finials

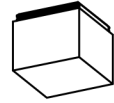

(D)  
Acrylic

Locate all hardware & components before discarding packaging

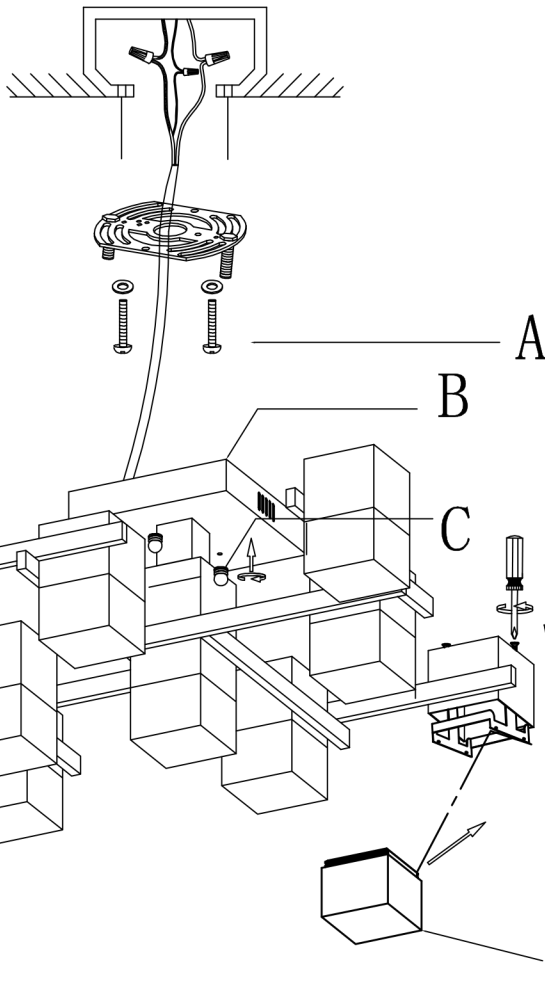

### Cleaning & Care

Clean with soft cloth and mild detergent. Do not use abrasive cleaner.

1.)

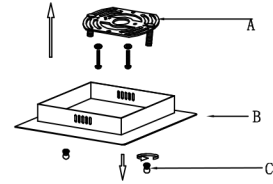

Step 1: Remove mounting bracket (A) from canopy (B) and install to electrical box.

2.)

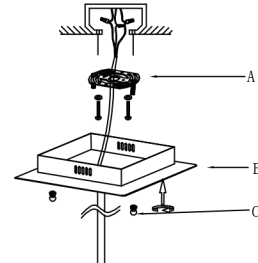

Step 2: Wire fixture to wires in outlet box. Green wire is for Ground. Install canopy to bracket and tighten finials on the canopy to secure.

3.)

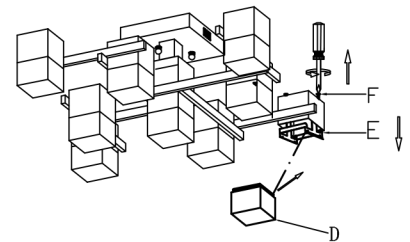

Step 4: Release the bracket from the cup, and slide Acrylic (J) onto bracket inside cup.

4.)

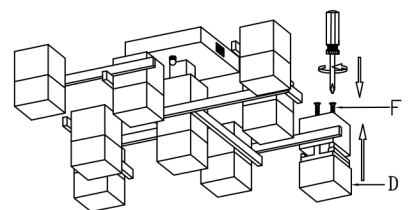

Step 5: Secure acrylic and bracket by tightening screws on top of the cup.