

Contemporary Lighting

PRODUCT NAME: Alumilux

ITEM NUMBER: E41404-SA / E41404-BZ / E41404-WT

Please consult your electrician for hanging fixture and wiring.

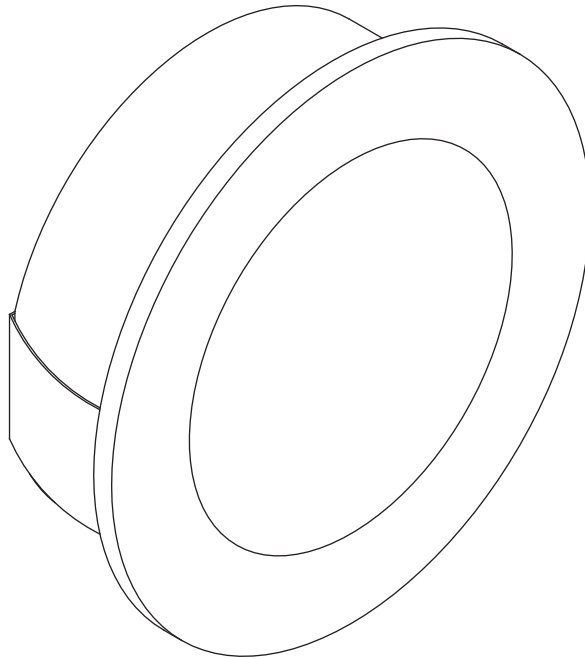

The fixture is designed to dim with a standard Triac forward phase dimmer. Dimming levels will vary by dimmer.

Below is a list of recommended dimmers:

- Lutron MACL-153M
- Lutron DVL-153P
- Lutron SCL-153P
- Leviton IPL06-10Z
- Leviton 6674-POW

Due to inrush current wattage should not exceed 150 watts of product for a 600 watt dimmer.

WARNING: Wires need to be connected to driver found in canopy and should not be connected directly to power source or a short may occur.

WARNING: Wires need to be connected to driver found in canopy and should not be connected directly to power source or a short may occur.

To prevent water intrusion, caulk around back-plate where fixture meets the wall using outdoor silicone sealant. Leave a small gap at the bottom to allow moisture to exit.

IMPORTANT: Turn off the power at the main fuse or circuit breaker box before starting installation

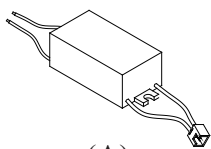

(A)
Driver

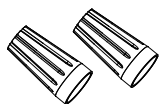

(B)
Wire Nuts (x2)

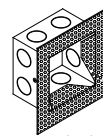

(C)
Item Number:5800
Outlet Box(not incl.)

Locate all hardware & components before discarding packaging

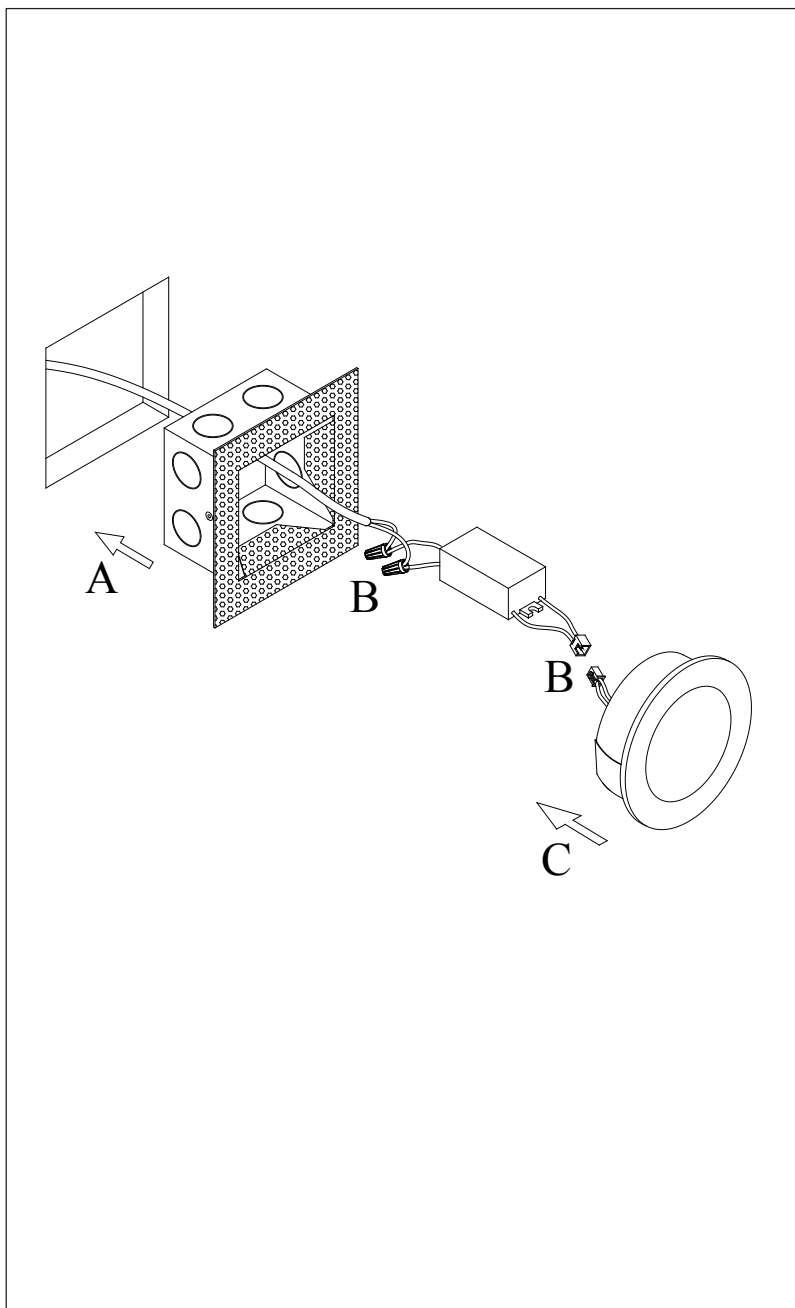

1.)

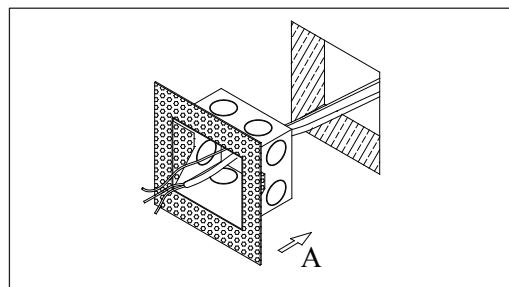

Step.1: Fix the outlet box to the hole.

2.)

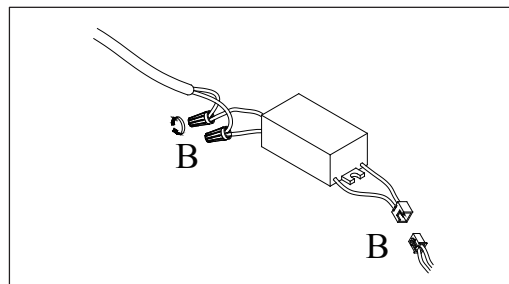

Step.2: Connect step light to driver provided.
Wire driver wires to low voltage supply wires.

3.)

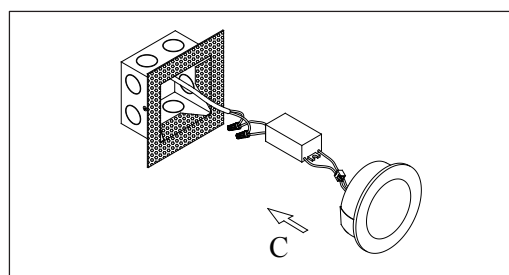

Step.3: Caulk around the housing with silicone sealant to prevent water intrusion.
Leave a gap at the bottom to let moisture escape. Then install fixture to housing.

Cleaning & Care:

Clean with soft cloth and a mild detergent.
Do not use abrasive cleaner.