

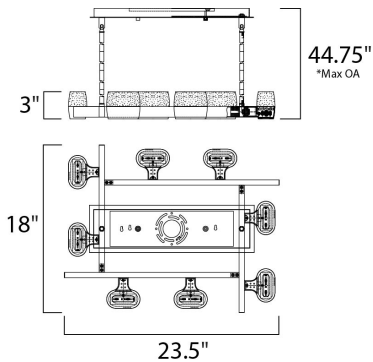

PRODUCT DESCRIPTION

This contemporary design feature oval shaped die cast cups finished in Polished Chrome which supports matching shape bubble glass shades. Each cup has dual LED modules which both light the glass shade above and provide down light below.



*max overall height

MEASUREMENTS

DIMENSION : 23.5" L x 18" W x 3" H
MAX OAH : 44.75" OAH
CANOPY : 1.25" W x 1" H x 17.5" L
HANGING WEIGHT : 23.1 lb

LAMPING

INPUT VOLTAGE : 120V
LUMENS : 3,360 Rated
BULB : 16 x 3W LED PCB Integrated , 48W Total
BULB INCLUDED : (Integrated)
DIMMABLE : Triac CL
COLOR_TEMP : 3000K
LIGHTING_DIRECTION : Both

FINISHES OPTION

 Bronze (BZ)

GLASS

Etched Bubble 89

RATINGS

cETLus
Location



ADDITIONAL

ADJUSTABLE
INSTALL UP/DOWN: Both
OPERATING TEMPERATURE:
-20°C (-4°F), 40°C (104°F)

Always consult a qualified electrician before installing any lighting product.



Contemporary
Lighting™

WESTERN DISTRIBUTION CENTER (HEADQUARTER)
253 NORTH VINELAND AVE | CITY OF INDUSTRY, CA 91746
EASTERN DISTRIBUTION CENTER
101 GARDNER PARK | PEACHTREE CITY, GA 30269
P. 626.956.4200 | F. 626.956.4225 | maximlighting.com